

## STOP AND FLOW CONTROL VALVES

### SV25

### VALVE SYMBOL

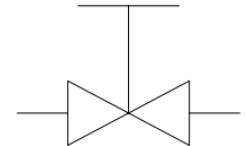

Gas or Liquid

300 Bar MWP

-50°C to  
+140°C

Semi Balanced

DN 25

Ø25.4 mm  
Nominal Bore

Cv: 15

Non - Rising  
Stem

Non - Rotating  
Stem

Weight: 9.3 Kg  
(Stainless Steel)

Bi-directional  
Flow

The SV25 manual valve can be used either as a flow control or stop valve where tight shut off is required.

Precision machined and fine finishes where required ensure excellent leak tight integrity, making this valve ideal for Hydrogen applications.

Semi balanced design ensures long life whilst operating at high pressures.

### MATERIALS

Body	See product selector
Stem (main valve)	431 Stainless Steel
Seat	See product selector
Back-up rings	PTFE
O-rings	See product selector
Handwheel	Aluminium Alloy
Trim	A4 Stainless Steel

## DIMENSIONS AND INSTALLATION DETAILS

SHOWN WITH 1-1/4" BSPP FEMALE CONNECTIONS.

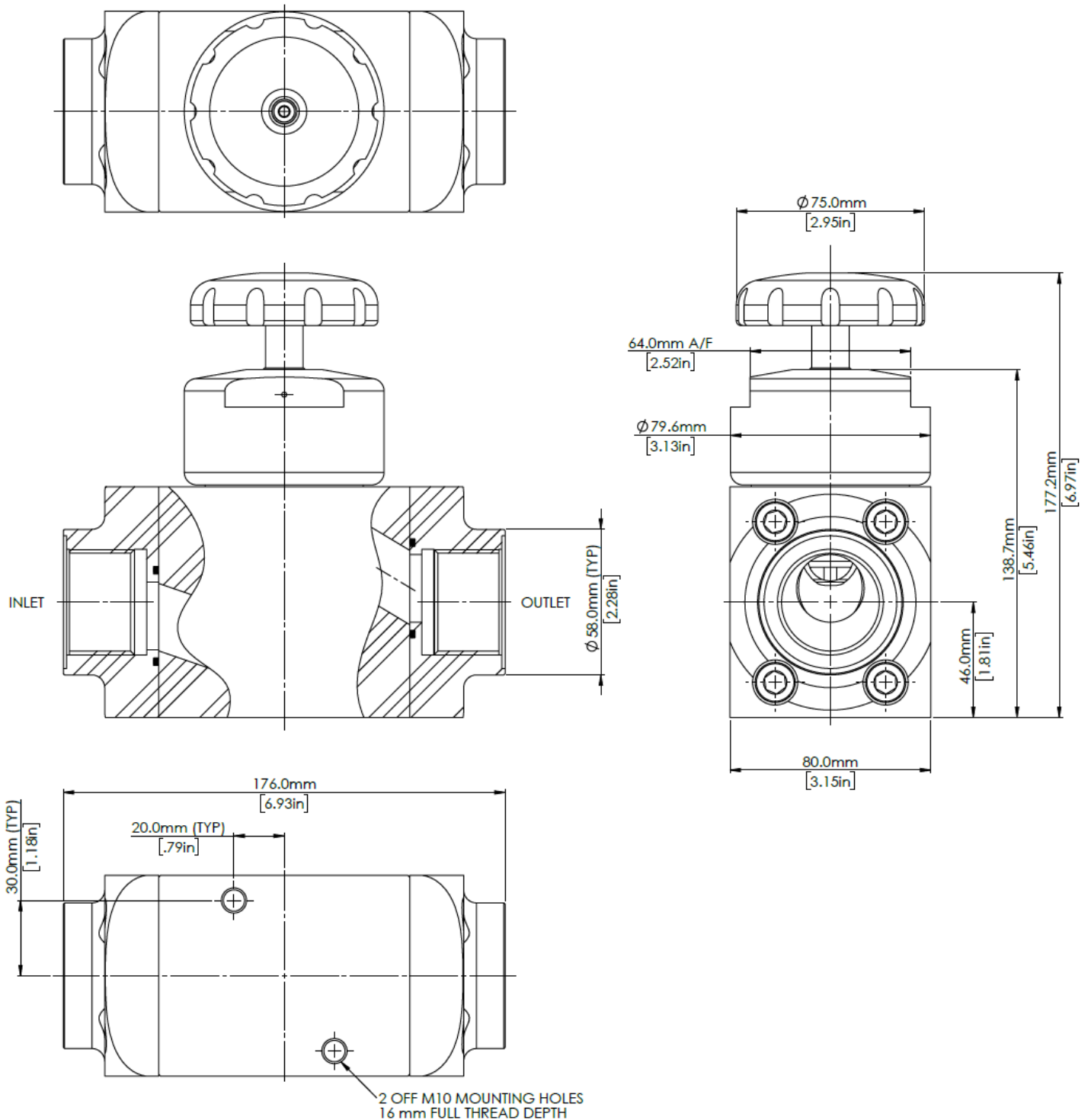



Designed and Manufactured in the UK

## MODEL CODE CONFIGURATOR COMPLETE VALVES

Product Type -	Porting Size -	Porting Type -	Material -	Seal Material -	Seat Material
SV25 -	1 (3/4")	FB (BSPP Female)	1 (Aluminium)	1 (EPDM) -50°C to +140°C	1 (Nylon)
	2 (1")	FN (NPT Female)	2 (Brass)	2 (FKM) -20°C to +140°C	2 (Peek)
	3 (1.25")	MB (BSPP Male)	3 (Stainless Steel)	3 (NBR) -30°C to +100°C	
	4 (1.5")	MN (NPT Male)		4 (HNBR) -35°C to +140°C	
	5 (2")				

*Example part number: SV25 – 3 – FB – 3 – 3 – 2*

*Other options available on request. Please contact Flow Products*

**Maximum working pressure**

All variants: 300 Bar.

### SERVICE KITS

Product Type -	Seal Material -	Seat Material
SV25 -	1 (EPDM)	1 (Nylon)
	2 (FKM)	2 (Peek)
	3 (NBR)	
	4 (HNBR)	

*Example part number: SV25 – 3 – 2*